



Welcome to our M.Studios (A + B)

The two, identically-sized TV studios (Studio A and Studio B) are among the most heavily used in the Netherlands. Stichting AKN (The AKN Foundation) operates the two studios on behalf of the broadcasters, AVROTROS and KRO-NCRV

IN GENERAL

The two, identically-sized TV studios (Studio A and Studio B) are among the most heavily used in the Netherlands. Stichting AKN (The AKN Foundation) operates the two studios on behalf of the broadcasters, AVROTROS and KRO-NCRV.

The TV studios are completely independent of one another, both physically and technically. This means that recordings can be made in both studios simultaneously. There is a HD production control room to which both studios can be linked up. In addition, there is the option to connect the studios to an OBV in just a few simple steps.

In the AKN studios, there are no contract partners for the operation of lighting or studio equipment (with the exception of lighting operation in studio B). There is the option to produce using the facility partner of your choice.

STUDIO A

Studio A is where the 'bigger', serial productions take place. The studio is directly adjacent to the transit area, from where it's easy to drive decors and technical materials into the studio. Another advantage of the studio is its lighting grid. This is fully equipped with hoists and each, numbered segment can be moved up and down independently of the others. This allows lighting operatives to quickly hang additional lights without having to use ladders or work platforms. People tell us they find the system extremely handy and a joy to use. In addition, sufficient

hoists in the grid have been equipped with DMX, XLR, Speakon (NL2) and HD-SDI connections.

STUDIO B

Studio B is mainly intended for programmes with a high frequency. Productions are given the option to leave their decor in the studio. Decor companies generally then need very little time to prepare the decor for recording. Combined with the fixed lighting grid, this ensures an extremely rapid start-up, and thus low production costs. The various lighting plans can be retrieved easily from the lighting computer's memory. The decor, lighting grid and ultimately the programme itself can therefore all be reproduced quickly and accurately on a daily basis.

PRODUCTION CONTROL ROOM & OTHER PRODUCTION AREAS

Both the production control room, as well as the connection points for outdoor broadcast trucks are linked up to the master control (MCR) in the Media Park. The direction is located right next to the studio. The outdoor broadcast trucks are located in an easily accessible spot in the studio delivery point/drop zone. As well as the visual & audio production and the studios themselves, the studio area also has two editing suites and six dressing rooms. Each dressing room has an LCD screen and is connected up to the internal HD-SDI network. So that, if wanted, the studio images can be viewed in any room. In addition, there are also two make-up areas.



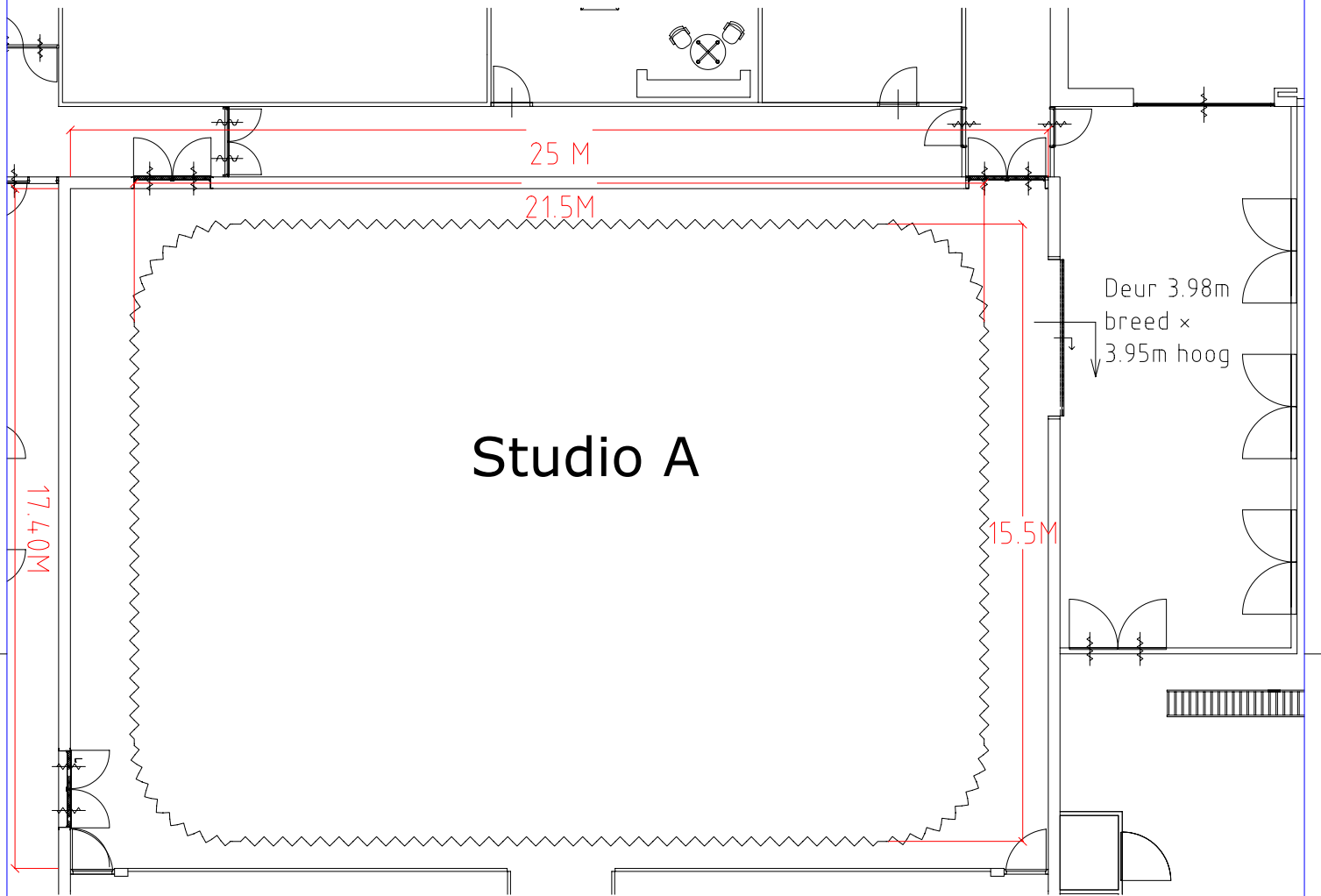

Hoogte Studio
5.5Meter

Discipline **Facilitair**
 Status
 Formaat **A3** Schaal **1:150**
 Getekend **JKO** Datum **5-3-21**

Adres **'s Gravelandseweg 80**
1217 EW, Hilversum
 Contact **035 671 4566**



Onderdeel van stichting AKN

Code	Datum	Omschrijving	Gewijzigd
------	-------	--------------	-----------

Omschrijving	Voorsteltekening Studio A
--------------	------------------------------

Bouwlaag	Kelder -1
----------	-----------

Tekeningnummer

GLW_-1_F2-Studio-A

Bestandsnaam **GLW_-1_F2-Studio.dwg**

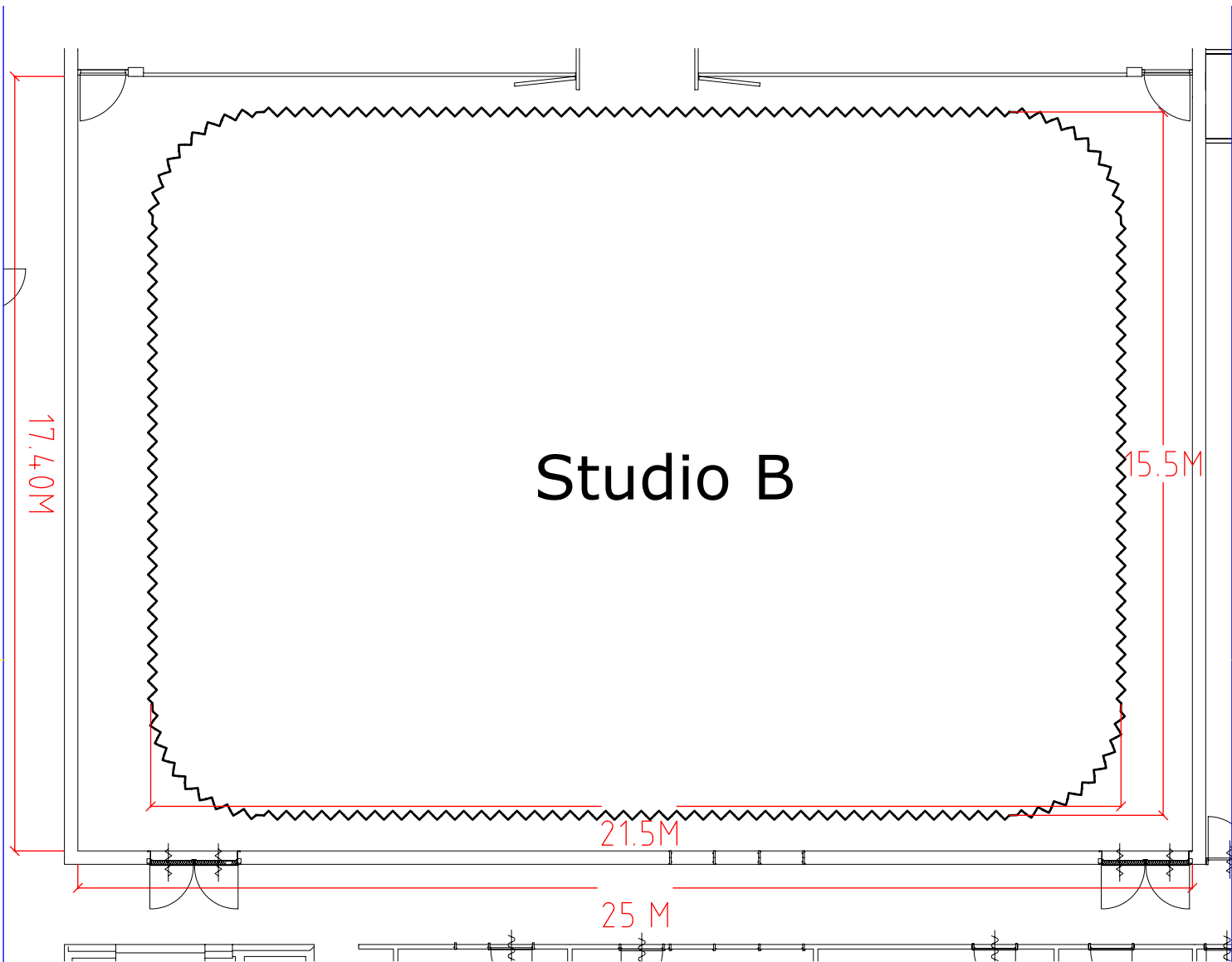

Studio B

Hoogte Studio
5.5Meter

Discipline	Facilitair	Code	Datum	Omschrijving	Gewijzigd
Status					
Formaat	A3	Schaal	1:150		
Getekend	JKO	Datum	5-3-21		
Adres	's Gravelandseweg 80 1217 EW, Hilversum	Omschrijving	Voorsteltekening Studio B		
Contact	035 671 4566	Bouwlaag	Kelder -1		
 <p>Onderdeel van stichting AKM</p>		Tekeningnummer			
		GLW_-1_F2-Studio-B			
		Bestandsnaam	GLW_-1_F2-Studio.dwg		

Deze tekening is in beheer bij PeoplePower. Voor vragen kunt u contact opnemen via AKN@neoplepower.nl